

Interface Compatibility Chart

Description	Analog	Screw	Description	Analog	Screw
BIOMET 3i®			Keystone/Lifecore		
Certain® 3.4 Implant	IMMILA	ILRGHG, ILRGHT	External Hex 3.3 Implant	R9893-34	R9203-34-48
Certain 4.1 Implant	IILA20	ILRGHG, ILRGHT	External Hex 3.75 Implant	R9891-40	R9202-40-48
Certain 5.0 Implant	IILAW5	ILRGHG, ILRGHT	External Hex 4.1 Implant	R9891-40	R9202-40-48
Certain 6.0 Implant	IILAW6	ILRGHG, ILRGHT	External Hex 5.0 Implant	R9893-50	R9203-50-48
External Hex 3.4 Implant	MMILA	UNISG, UNIHG, UNIHT	External Hex 6.0 Implant	R9893-50	R9203-50-48
External Hex 4.1 Implant	ILA20	UNISG, UNIHG, UNIHT	Lifecore Prima 3.3 Internal Implant	45140K	45060K
External Hex 5.0 Implant	ILAW5	UNISG, UNIHG, UNIHT	Lifecore Prima 4.0 Internal Implant	45141K	45060K
External Hex 6.0 Implant	ILAW6	UNISG, UNIHG, UNIHT	Lifecore Prima 5.0 Internal Implant	45142K	45060K
Standard Abutment	SLA20	GSH30, GSH70	Prima Connex Multi 3.9 Abutment	45160K	45164K
IOL® Abutment	IOLLAS	GSH30, GSH70	Fixed Detachable Abutment	410530-4	R9460-48
Conical Abutment 3.4	MMCLA	GSH30, GSH70	Nobel Biocare™		
Conical Abutment 4.1	CLA20	GSH30, GSH70	Brånemark System® Mk III 3.3 NP Implant	31158	29282
Conical Abutment 5.0	CLA20	GSH30, GSH70	Brånemark System Mk III 4.1 RP Implant	31159	29283
Conical Abutment 6.0	WCLA6	GSH30, GSH70	Brånemark System Mk III 5.0 WP Implant	31160	29284
Pre-Angled Conical 17° Abutment	CLA20	GSH30, GSH70	Replace® Select 3.5 NP Implant	29498	29474
Pre-Angled Conical 25° Abutment	CLA20	GSH30, GSH70	Replace Select 4.3 RP Implant	29500	29475
DENTSPLY Friadent®			Replace Select 5.0 WP Implant	29502	29475
Ankylos Plus 3.5 Implant	3104 5270	3102 1505	Replace Select 6.0 WP Implant	29995	29475
Ankylos Plus 4.5 Implant	3104 5272	3102 1505	Replace HL™ 4.5 External Hex Implant	43714	2699
Ankylos Plus 5.5 Implant	3104 5274	3102 1505	Replace HL 5.0 External Hex Implant	5052	2699
XiVE S 3.4 Implant	45-4030	45-4305	NobelActive™ Internal 3.5 NP Implant	34243	31171
XiVE S 3.8 Implant	45-4040	45-4305	NobelActive Internal 4.3 RP Implant	34244	28815
XiVE S 4.5 Implant	45-4050	45-4305	NobelActive Internal 5.0 RP Implant	34244	35260
XiVE S 5.5 Implant	45-4060	45-4305	PME 4.5 Abutment	DCB-1750	DCA-074
Ankylos Balance Base Abutment	3104-5330	3105-6021	PME 5.0 Abutment	2128	2346
Friadent MP 3.4 Abutment	45-4103	45-4206	Standard Abutment	DCB 175-0	DCA-074
Friadent MP 3.8 Abutment	45-4103	45-4206	Brånemark System Multi-unit NP Abutment	31161	29285
Friadent MP 4.5 Abutment	45-4103	45-4206	Brånemark System Multi-unit RP Abutment	31161	29285
Friadent MP 5.5 Abutment	45-4103	45-4206	Brånemark System Multi-unit WP Abutment	31162	29286
AstraTech			Straumann®		
20° UniAbutment 3.5/4.0	22069	22435	Straumann 3.5 NN Implant	48.130	49.177
20° UniAbutment 4.5/5.0	22069	22435	Straumann 4.8 RN Implant	48.124	49.181
45° UniAbutment 3.5/4.0	22070	22435	Straumann 6.5 WN Implant	48.171	49.181
45° UniAbutment 4.5/5.0	22070	22435	Straumann Bone Level 3.3 NC Implant	25.2101	25.2906
NOTE: 20° and 45° abutments cannot be combined in same bar			Straumann Bone Level 4.1 RC Implant	25.4101	25.4906
BioHorizons®			Straumann Bone Level 4.8 RC Implant	25.4101	25.4906
3.5 External Implant	293-000	130-300	SynOcta 4.8 RN Abutment	48.124	048.350V4
4.0 External Implant	294-000	140-300	SynOcta 6.5 WN Abutment	48.171	048.350V4
5.0 External Implant	295-000	140-300	Zimmer®		
6.0 External Implant	296-000	140-300	Advent 4.5 Implant	AVR	AVHLS
3.5 Internal Implant	PYIA	PXAS	Screwvent 3.5 Implant	IA3	MHLAS
4.5 Internal Implant	PGIA	PXAS	Screwvent 4.5 Implant	IA4	MHLAS
5.7 Internal Implant	PBIA	PXAS	Screwvent 5.7 Implant	IA5	MHLAS
6.0 Internal Implant	PBIA	PXAS	Spline 3.25 Implant	400983	1537
3.5 Abutment	254-600	222-100	Spline 4.0 Implant	04024X9	1537
4.0 Abutment	254-600	222-100	Spline 5.0 Implant	10573	1537
5.0 Abutment	255-600	222-100	TaperLock 4.1 Implant (Ex Hex)	IAX	GPCAS
CAMLLOG			Calcitek 4.0 MD Abutment*	*	*
Camlog Bar 3.3 Abutment	J3020.4300	J4005.1602	Calcitek Integral 3.25 SD Abutment*	*	*
Camlog Bar 3.8 Abutment	J3020.4300	J4005.1602	Corvent TSA Abutment*	*	*
Camlog Bar 4.3 Abutment	J3020.4300	J4005.1602	Corvent TSI Abutment*	*	*
Camlog Bar 5.0 Abutment	J3020.6000	J4005.2002	Tapered 3.5 Abutment	ACTR	SCTS
Camlog Bar 6.0 Abutment	J3020.6000	J4005.2002	Tapered 4.5 Abutment	ACTR	SCTS
Sybron/Innova			Tapered 5.7 Abutment	ACTR	SCTS
Endopore 3.5 External Hex Implant	06M-IA/1	05-2RS	Please call the manufacturer for all non BIOMET 3i Components.		
Endopore 4.1 External Hex Implant	06B-IA/1	05-2RS	*Please call Attachments International 800-999-3003 or 650-340-0393		
Endopore 5.0 External Hex Implant	06WB-IA/1	05-2RS			
Endopore 4.1 Internal Implant	06I-PIA	05B-2RS			
Endopore 5.0 Internal Implant	06WI-PIA	05B-2RS			
UMA 3.9 Abutment	07-0015	07-00522			



Global Headquarters
4555 Riverside Drive
Palm Beach Gardens, FL 33410
1-800-342-5454
Outside The U.S.: +1-561-776-6700
Fax: +1-561-776-1272
www.biomet3i.com

**To Receive Information About BIOMET 3i's Products, Services And Events
By Email, Visit Our Website At www.biomet3i.com**

CAM StructSURE, Certain and IOL are registered trademarks of BIOMET 3i LLC. BIOMET is a registered trademark and BIOMET 3i and design are trademarks of BIOMET, Inc. Brånemark System and Replace are registered trademarks and NobelActive, Nobel Biocare and Replace HL are trademarks of Nobel Biocare AB. Advent, Screw-Vent, Spline and Zimmer are registered trademarks and TaperLock is a trademark of Zimmer Dental. Biohorizons is a registered trademark of Biohorizons, Inc. Endopore is a registered trademark of Innova LifeSciences Corporation. Straumann and SynOcta are registered trademarks of Straumann AG. Ankylos, Friadent, Frialit and XiVe are registered trademarks of Dentsply Friadent Ceramed. Dolder is a registered trademark of Prof. Eugen Dolder.
©2009 BIOMET 3i LLC. All rights reserved.

CAM StructSURE® Precision Milled Bars And Frameworks Design Options And Interface Compatibility

Hybrid Design #1



- Fixed prosthesis
- Metal lingual
- Low buccal finish line

Hybrid Design #2



- Fixed prosthesis
- Designed for easy hygiene
- Metal lingual
- Buccal and lingual finish lines

Wrap Around Bar



- Fixed prosthesis
- Acrylic resin wraps around the bar

Freeform Bar



- Fixed prosthesis
- Acrylic resin wraps around the bar

Canada Bar



- Fixed hybrid bar
- Removable prosthesis engages bar

Dolder® Eggshape



- Removable overdenture design
- Clips allow for anterior/posterior rotation of the denture

Dolder U Shape



- Removable overdenture design with clips for more rigid fit
- Clips allow for anterior/posterior rotation of the denture
- Provides lateral stability to denture

Hader Bar



- Removable overdenture design with clips that engage undercuts
- Provides some lateral stability
- 4mm between implants is needed for clips

Primary Bar



- Most secure removable overdenture design
- May be used with attachments or secondary casting
- Bar can be designed with a 2° – 6° taper

Combination Primary With Hader Or Dolder



- Combines a milled bar with Hader or Dolder designs
- Excellent lateral stability
- Bar can be designed with a 2° – 6° taper

Copy Milled



- Fixed or removable bar prosthesis
- Framework for fixed prosthesis
- Technician fabricated resin pattern for porcelain or acrylic bonded to titanium

New Design Features

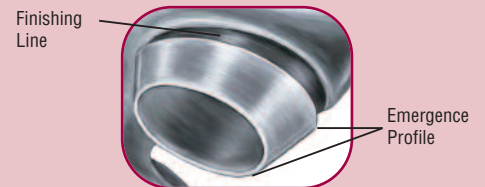

Implant Cylinder Extensions

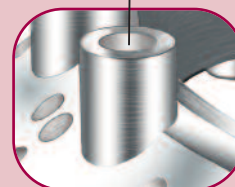

Stability Struts

Ask for these design features on the CAM StructSURE Work Order Form (ART880).

